

GROSS BLDG SQ. FOOTAGE TOTALS	
TYPE OF SF.	TOTAL
Units	397 units
LEASABLE (NRSF):	
Residential	345,243 sf
Commercial	10,591 sf
Resi Storage	866 sf
Leasable Sub-Total	356,700 sf
NON LEASABLE:	
Lobby, Amenity, Leasing, Mail & Package	16,020 sf
Sub-Total	16,020 sf
Corridors, Trash Chute, Closets	46,947 sf
Vertical Circ.	9,786 sf
B.O.H.	3,829 sf
Sub-Total	60,562 sf
Non Leasable Sub-Total	76,582 sf
Sub-Total	433,282 sf
Garage	180,307 sf
Outdoor Covered Area, Paseo (Retail)	6,521 sf
TOTAL	620,110 sf

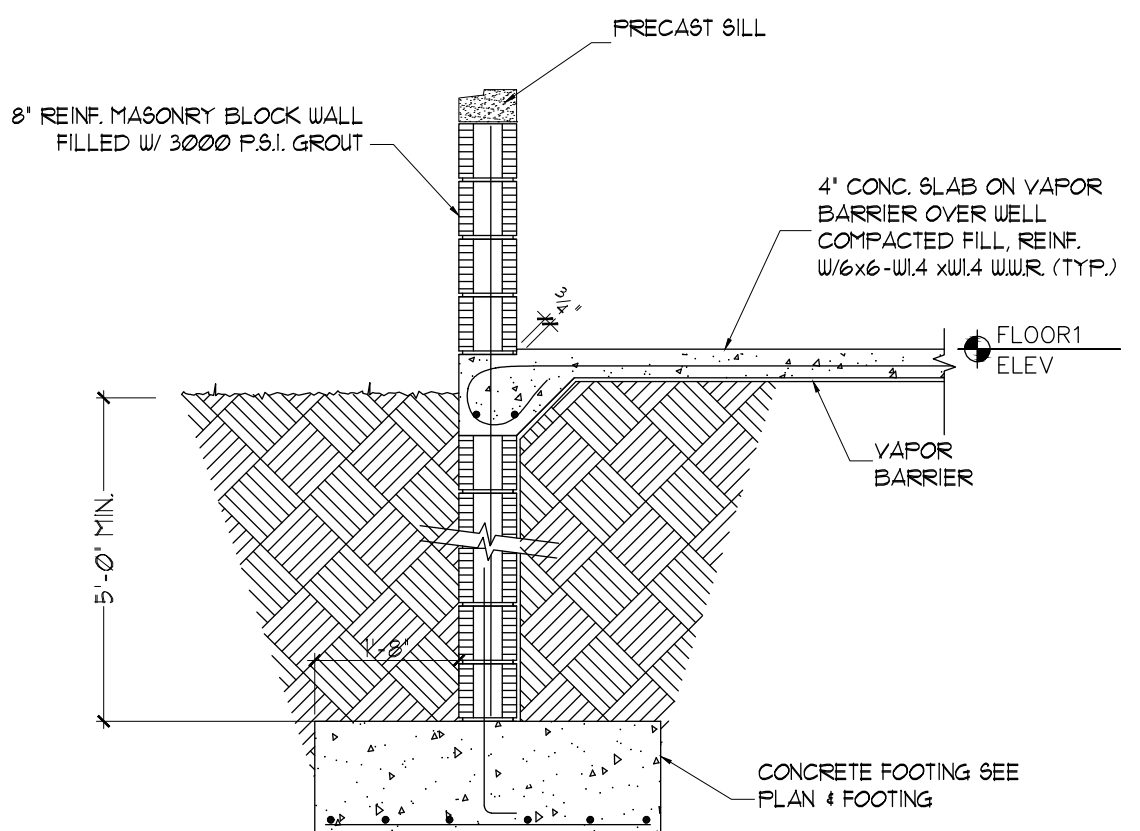

CONCEPTUAL FOOTER SECTION

SCALE: N.T.S.

NOTE: REFER TO CIVIL SHEETS FOR SITE PLAN DETAILS AND SITE INFORMATION.



LEVEL 1
35 DU'S
GARAGE: 94 SP
SURFACE: 29 SP

P&Z
SCALE: 1" = 30'-0"

PZ25-16500002

08/27/2025

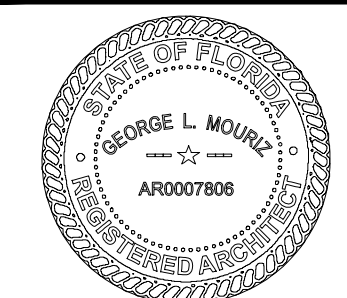
[illegible]

GEORGE L. MOURIZ
AR0007806

POMPANO BEACH APTS
LOCATED AT:
POMPANO BEACH
FOR:
PORTMAN HOLDINGS

ARCHITECT'S BUILDING CODE STATEMENT/
TO THE BEST OF THE ARCHITECT'S
KNOWLEDGE THE PLANS AND SPECIFICATIONS
COMPLY WITH THE FLORIDA BUILDING CODE
EIGHTH EDITION (2023) AND THE
APPLICABLE FIRE SAFETY STANDARDS AS
DETERMINED BY THE LOCAL AUTHORITY
AND CHAPTER 633 FLORIDA STATUTES.

COPYRIGHT © 2024 MSA ARCHITECTS, INC.
THE ARCHITECTURAL DESIGN AND DETAIL
DRAWINGS FOR THIS BUILDING AND/OR
OVERLAPPING ARE THE SOLE PROPERTY OF
MSA ARCHITECTS, INC. ALL RIGHTS ARE
RESERVED BY THE ARCHITECT, THEIR USE
FOR REPRODUCTION, CONSTRUCTION, OR
DISTRIBUTION IS PROHIBITED UNLESS
AUTHORIZED IN WRITING BY THE ARCHITECT.



**MSA
ARCHITECTS, INC.**
8950 SW 74TH CT #1513
MIAMI, FL 33156
P: (305) 273-9911



MSA
ARCHITECTS
ARCHITECTURE & PLANNING

Project No: 2254.prj
Contract Date:
Scale:
TITLE:

SHEET:

A-2.1